

MODEL NOTE:

- TOP WALL HAS INNER WYTHER EXTENDED 9 1/2" AND VOID PLACED OVER WYTHER AT INSULATION LAYER
- BOTTOM PANEL HAS INNER WYTHER AND INSULATION EXTENDED 6"

DETAIL NOTE:

PANEL INSULATION REDUCED @
PANEL BASE TO ACCOMMODATE
STUD IN 4 1/2" x 3" x 4 1/2" PANEL

REDUCE INSULATION TO
1"x8"x12"

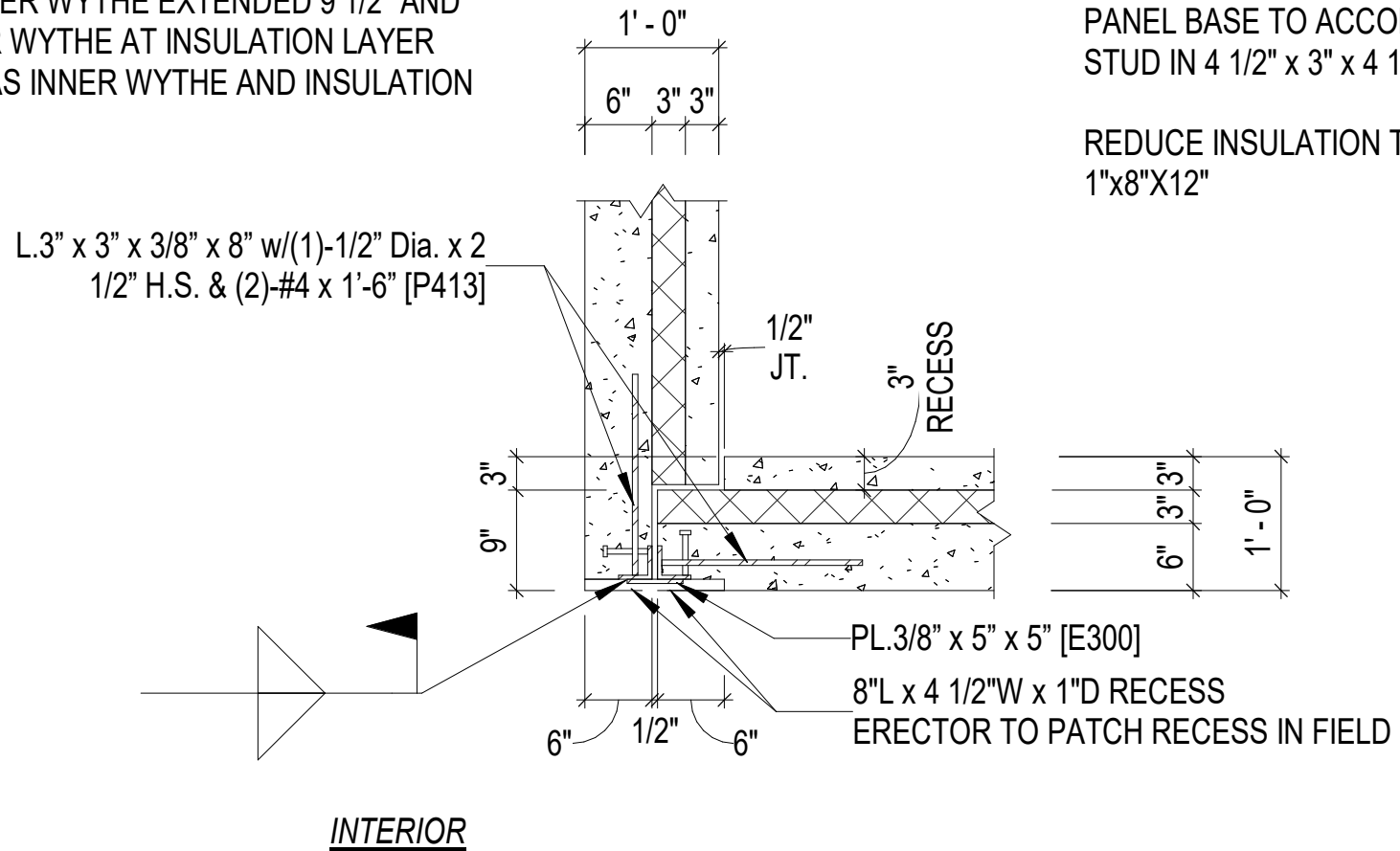

1 MID-WALL CONNECTION 5