

Extruded Hollow Core

PRESTRESSED CONCRETE SLAB

12" X 48" Light Section

Safe Load Table

UNIFORMLY DISTRIBUTED SUPERIMPOSED SERVICE LOAD IN PSF

Standard Designation	Strands No. & Size	Strand Area Sq. In.	M Ft.-Kips per Unit	ϕM_n Ft.-Kips Per Unit	Span Length (L) in Ft.																																													
					15	16	17	18	19	20	21	22	23	24	25	26	27	28	29	30	31	32	33	34	35	36	37	38	39	40	41	42	43	44	45	46	47	48	49	50										
1248-130	6 - 6/10	1.302	168.6	239.4	732	683	639	600	565	534	506	480	457	435	415	383	350	322	296	272	251	232	215	199	184	171	159	147	137	127	118	110	102	94	87	79	73	66	60	55										
1248-117	4 - 6/10 & 2 - 1/2	1.174	157.0	217.6	732	683	639	600	565	534	506	480	454	412	375	342	313	287	263	242	223	206	190	175	162	150	139	128	119	110	102	94	87	81	74	68	62	56	51											
1248-92	6 - 1/2	0.918	133.9	173.0	732	683	639	600	539	481	430	387	349	315	286	260	237	216	197	180	165	151	139	127	117	107	98	90	82	75	69	63	57	52																
1248-62	4 - 1/2	0.612	106.3	117.6	594	514	449	394	347	308	273	244	218	195	175	158	142	128	115	103	93	84	75	67	60	53																								

controlled by: ultimate shear service

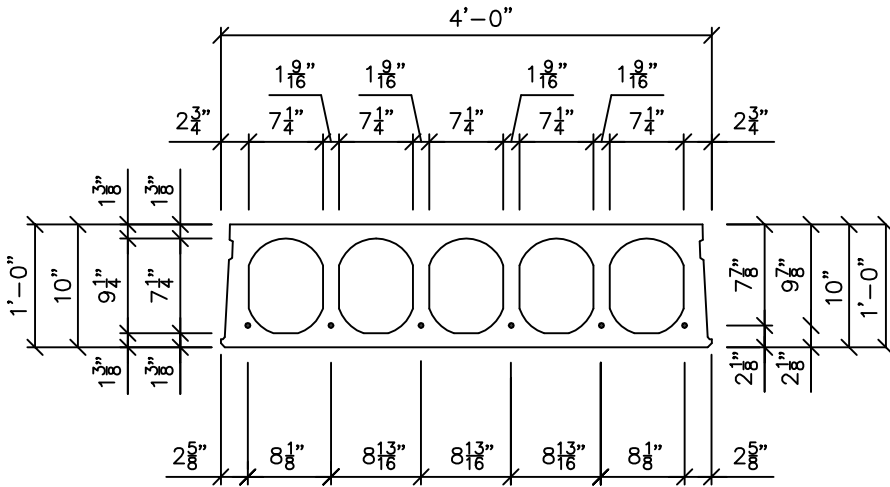

$A = 285.12 \text{ in}^2$ $f'_c = 9000 \text{ psi}$
 $b_w = 10.626 \text{ in}$ $f'_{ci} = 3500 \text{ psi}$
 $I_g = 5248 \text{ in}^4$ $f_{pu} = 270 \text{ ksi}$
 $y_b = 6.095 \text{ in}$

NOTES:

- 1) Grouted weight of structural unit is 80 psf or 320 plf based on concrete unit weight of 154 pcf.
- 2) Design is based on ACI Standard, "Building Code Requirements for Reinforced Concrete (ACI318)."
- 3) No shear reinforcement is required for the tabulated loads to the right of the heavy stepped line.
- 4) Tabulated loads are based on $U=1.2D+1.6L$ and with all load superimposed on the structural section considered as live load.
- 5) Tabulated loads in the blue area may be achieved by adding partial concrete corefill.
- 6) Tabulated loads in yellow are controlled by permissible flexural tension at service loads.
- 7) Tabulated loads in bold font have deflections in excess of $L/360$.
- 8) All strand stressed to 70% of ultimate.
- 9) For longer spans and conditions not covered in the load table, consult Molin.



Molin Concrete Products Company • 415 Lilac Street • Lino Lakes, MN 55014
 Office: 651.786.7722 • 800.336.6546 • Fax: 651.786.0229
 www.molin.com • e-mail: info@molin.com

Hollow Core - Extruded 12" X 48" Light Section